

SOFTWARE SETUP

Using CSUM06 & CSDM04 with PC (Windows 7, 8.1, 10 or higher)

- i. Connect to your PC using the supplied USB cable
- ii. Go to the start menu and select the control panel
- iii. Click on the sound icon from the control panel
- iv. In the recording tab, select JBL Commercial CSUM06
- v. In the playback tab, select JBL Commercial CSDM04
- vi. Set the output volume to comfortable level

Using CSUM06 with Mac (Mac OS 10.10 or higher)

- i. Connect to your Mac using the supplied USB cable
- ii. Open system preferences and select the sound icon
- iii. In the input tab, select JBL Commercial CSUM06
- iv. In the output tab, select JBL Commercial CSDM04
- v. Set the output volume to comfortable level

All product images shown are for illustration purpose only and may not be an exact representation of the product. Actual product may vary in colour, size and finishing. ©2021 HARMAN International Industries, Inc. All rights reserved.



WFH100

USB MIC & SPEAKER BUNDLE

USER GUIDE

Thank you for choosing JBL Commercial WFH100 USB mic & speaker bundle. WFH100 is an easy to set-up bundle that includes the CSUM06 mini USB microphone and the CSDM04 USB powered speakers. With the WFH100 bundle you can be sure to hear and be heard clearly.



BOX INCLUDES

- i. CSUM06 mini USB microphone
- ii. CSDM04 USB powered speakers
- iii. USB cable

CONNECTING THE SPEAKER

Connect the CSDM04 with the computer using the USB cable that is attached to the speaker. Rotate the volume knob clockwise till it clicks & the speaker turns ON. The white LED will turn ON indicating that it is receiving power.

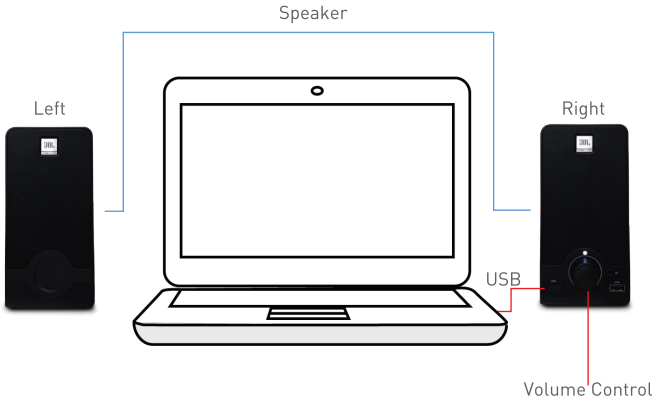

FEATURES

- i. Easy to setup
- ii. Powered by single USB cable
- iii. Built-in 2 x USB ports
- iv. Compact & stylish design
- v. Microphone with cardioid pickup pattern
- vi. USB plug-&-play operation
- vii. Convenient mute switch

SPECIFICATIONS

CSUM06 MINI USB MICROPHONE	CSDM04 USB POWERED SPEAKERS
Transfer protocol: USB 2.0	Frequency range: 80 – 20KHz
Transducer: 14mm condenser capsule	Rated input power: 2.5W x 2
Polar pattern: cardioid	Driver size: 2.5 inch
Frequency range: 50Hz – 18KHz	Bit depth: 16 Bit
Bit depth: 16 Bit	Sample rate: 44.1/48 KHz
Sample rate: up to 48 KHz	Sensitivity: 79dB SPL +/- 3dB
Maximum SPL: 120dB (THD≤0.5% @1KHz)	Maximum peak SPL: 83dB
Power requirement: 5V USB/150mA	Power requirement: 5V USB/500mA - 2A
Dimensions: Height: 124mm, Dia. including Base: 63mm	Dimensions: H173 x W85 x D100mm
Weight: 159g	Weight: 959g

FREQUENCY RESPONSE CURVE CSUM06 MINI USB MICROPHONE

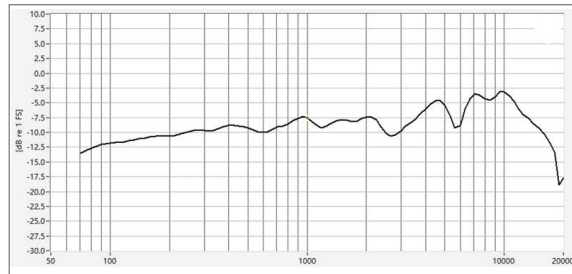

FREQUENCY RESPONSE CURVE CSDM04 USB POWERED SPEAKERS

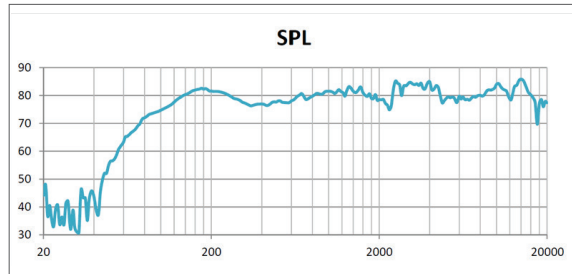

The speaker with the volume control is the right speaker. Connect the cable with RCA connector to the other speaker which is the left speaker. Adjust the volume control of the speaker according to your need.

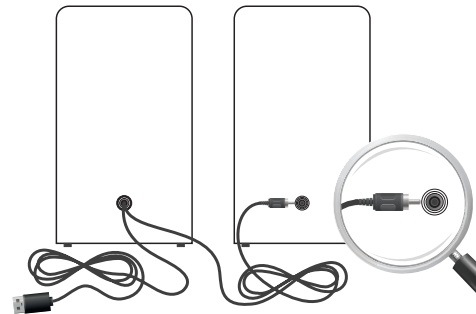

The headphone port can be used to connect a wired headphone. As soon as the headphone is connected, the speakers will be muted. The volume knob controls level for both speaker & headphone out.



CONNECTING THE MICROPHONE

The CSUM06 USB microphone can be connected to any of the USB ports on the right speaker using supplied cable. The other port can be used to connect USB devices such as thumb drives & card readers to the computer.

Once the CSUM06 is connected to the computer, the LED on the microphone will glow white indicating that the mic is ON. The drivers for the microphone will auto-install & it will be ready to use in a few minutes. This microphone captures sound from the front & not from the top.

CSUM06 mini USB microphone & CSDM04 USB powered speakers can be used separately as well.

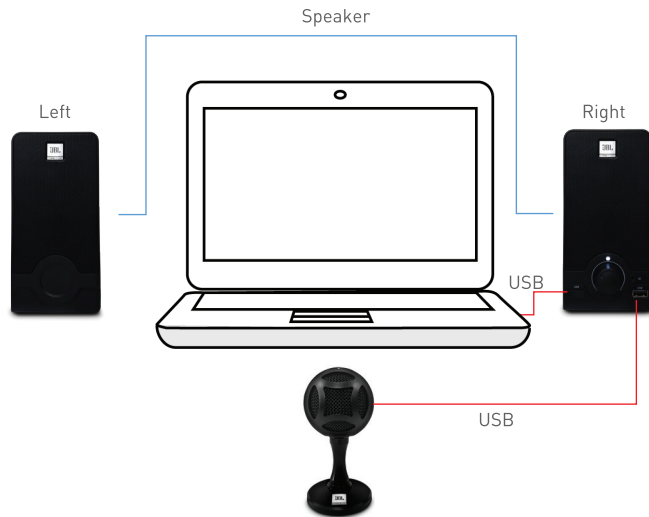

MICROPHONE CONTROLS

Mute button: Press to Mute/Unmute the microphone. The LED in the front will indicate the status.
White LED: Microphone picks up sound normally. Red LED: Microphone is in mute state

